

ISSN 1614-4600 · JAN · FEB
£13 · US\$24.50 · €18.90

English Edition

DETAIL

Review of Architecture and Construction Details · Refurbishment · Vol. 2016 · 1

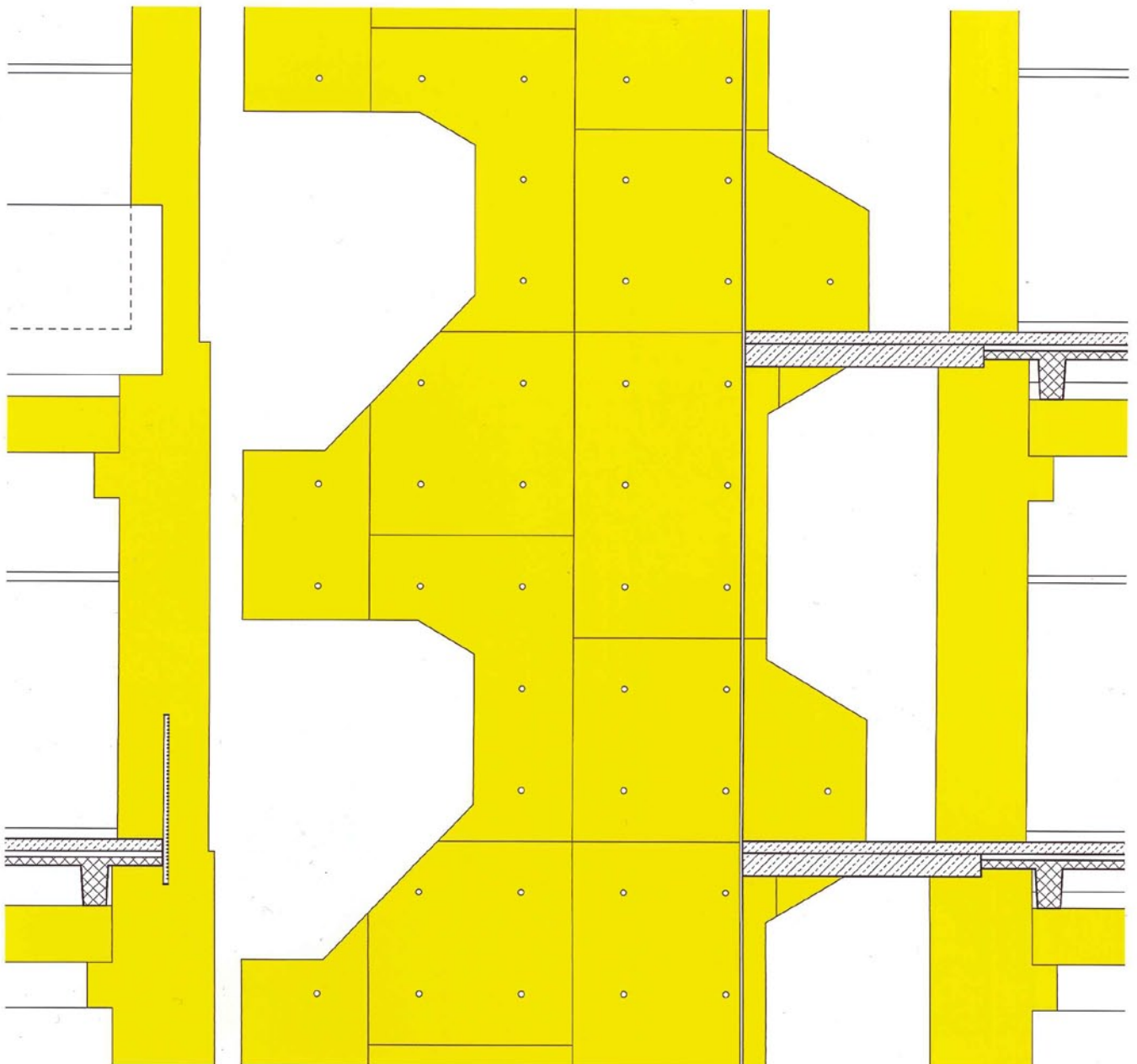



Modern techniques used to decorative effect

The Lebanese restaurant Al Sultan in London's Mayfair recently underwent a redesign by interiors company IDEA. The key feature is the decorative metal grille in a traditional Islamic pattern, reworked for a more contemporary feel. In laser-cut aluminium, powder-coated in golden tones, the grille is lit from both the front and back to give an otherwise tight space the illusion of volume. It wraps itself around the curved shape of the white lacquered bar and appears to weave around the whole restaurant.

Custom-built ring chandeliers throughout the space reflect an amber shimmer on the Venetian stucco of the ceiling. The bespoke wenge and walnut sunburst parquet floor is again reminiscent of traditional Islamic ornamentation, and a lacquered sunburst walnut chef's table is placed in the main part of the restaurant. The clean lines of the sofas and chairs are a deliberate artistic complement

to the detailed patterns on the walls and floor, explained IDEA. The interiors and branding company is based in Sofia, Bulgaria and provides design services across Europe. With the exception of the chairs, by Italian company Calligaris, almost everything in the restaurant is a bespoke creation based on its designs, produced in Bulgaria and assembled in the UK.

The parquetry is by Artistico. The grille was CNC-cut by Lock Furniture, which also produced the shells for the chandeliers in the same pattern. The LED lighting and lighting controls are by Pixel Factory, a subsidiary of IDEA that delivers complex lighting systems and solutions to commercial properties.

□ IDEA International
United Kingdom
☎ +44 (0)7741 803988
www.ideainteriors.co.uk

Relaxing in two ways

Made in Italy, this leather swing chair from Keir Townsend makes an interesting focal point and comes as a floor-standing chair, featuring a black base, or suspended from a metal chain. The tubular chrome frame is available in satinised nickel and other finishes. Dimensions are 120 x 75 cm. The design studio provides a full scope of services for residential and commercial interiors from initial concept and branding through to design implementation. The company also offers a selection of furniture, flooring, lighting and accessories from its retail showroom in central London, sourced from around the world, alongside design classics and pieces by new emerging talents, exhibited in the context of a real living space.

□ Keir Townsend
United Kingdom
☎ +44 (0)20 7746 2442
www.keirtownsend.com

